

LEGEND:

- Ø DIAMETER
- R RADIUS
- ° DEGREES
- └ COUNTERBORE/
SPOTFACE
- ∨ COUNTERSINK
- ▽ DEPTH
- CUBED

GENERAL NOTES:

ALL FILLETS HAVE R.12" UNLESS OTHERWISE NOTED
ALL CHAMFERS ARE .06" BY 45° UNLESS OTHERWISE NOTED

PARTS LIST				
ITEM	QTY	PART NUMBER	MATERIAL	DESCRIPTION
1	1	AXLE	STEEL	
2	1	BUSHING	BRONZE	OILLESS
3	1	HUB	ALUMINIUM	
4	1	COLLAR	ALUMINIUM	
5	2	PANEL RING	ALUMINIUM	.12" UNIFORM THICKNESS
6	1	WHEEL	HARD RUBBER	
7	6	RIVET	STANDARD	Ø.31, 1.00" INSIDE LENGTH, EQUALLY SPACED (MCMaster-CARR 97300A709)
8	2	WASHER	STANDARD	I.D. 1.00", O.D. 2.12", .18" THICK
9	1	SPRING PIN	STANDARD	Ø.25, 1.875" LONG (MCMaster-CARR 98296A932)



WHEEL ASSEMBLY
SCALE 1 / 2

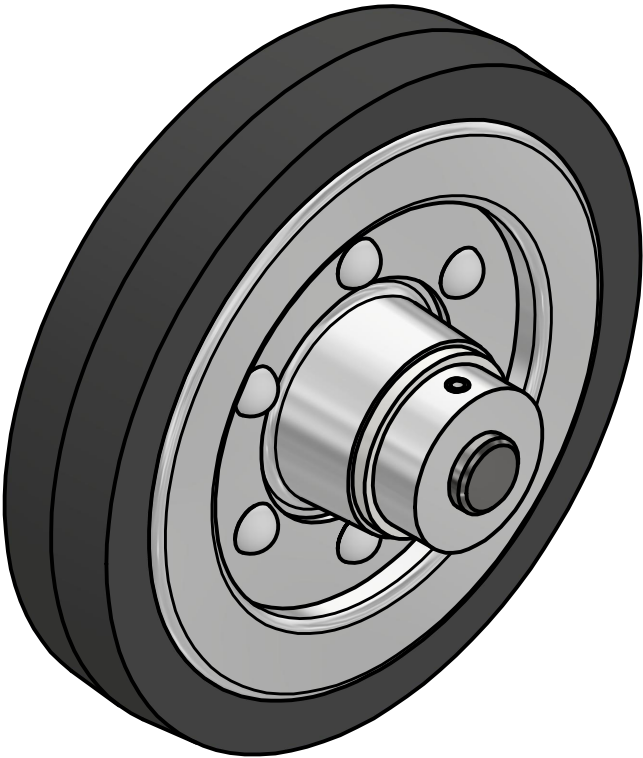

WHEEL ASSEMBLY (ALT VIEW)
SCALE 1 / 2



DIGITAL DESIGN
GRAPHICS
TECHNOLOGY

WWW.DDGT.NET

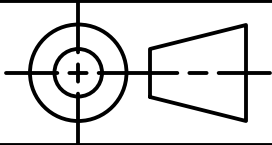

TOLERANCES UNLESS SPECIFIED:
DECIMAL INCHES:
X = ±.020
XX = ±.010
XXX = ±.005
FRACTIONAL ±1/64"
ANGLES ±1 DEGREE
SURFACES ³²✓

CLASS: DDGT 121

ASSIGNMENT #: XX

INVENTOR DRAWING NAME:
WHEEL ASSEMBLY

FIG #: 11-55

MANAGER: G. STROMMEN

DRAFTER: K. MILLER

DATE: 5/17/2025

SCALE: AS NOTED

PAGE #: 1 OF 3

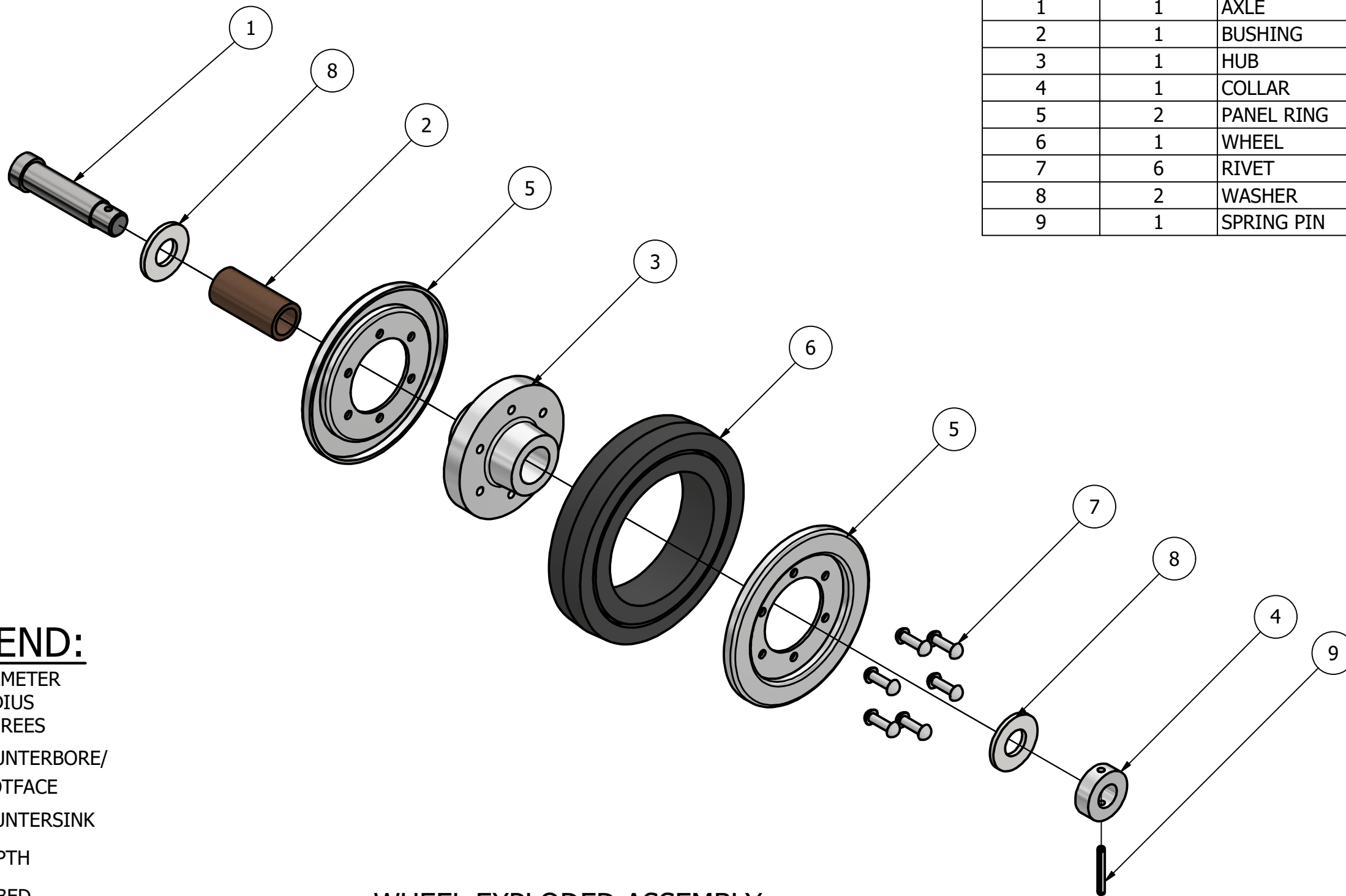

PARTS LIST		
ITEM	QTY	PART NUMBER
1	1	AXLE
2	1	BUSHING
3	1	HUB
4	1	COLLAR
5	2	PANEL RING
6	1	WHEEL
7	6	RIVET
8	2	WASHER
9	1	SPRING PIN

LEGEND:

- Ø DIAMETER
- R RADIUS
- ° DEGREES
- ┐ COUNTERBORE/
SPOTFACE
- ✓ COUNTERSINK
- ↯ DEPTH
- CUBED

GENERAL NOTES:

ALL FILLETS HAVE R.12" UNLESS OTHERWISE NOTED
ALL CHAMFERS ARE .06" BY 45° UNLESS OTHERWISE NOTED

WHEEL EXPLODED ASSEMBLY
SCALE 1 / 4

DDGT

DIGITAL DESIGN
GRAPHICS
TECHNOLOGY

WWW.DDGT.NET

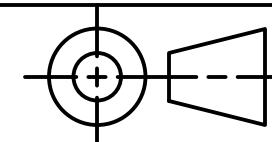

TOLERANCES UNLESS SPECIFIED:
DECIMAL INCHES:
X = ±.020
XX = ±.010
XXX = ±.005
FRACTIONAL ±1/64"
ANGLES ±1 DEGREE
SURFACES ³²✓

CLASS: DDGT 121

ASSIGNMENT #: XX

INVENTOR DRAWING NAME:
WHEEL ASSEMBLY

FIG #: 11-55

MANAGER: G. STROMMEN

DRAFTER: K. MILLER

DATE: 5/17/2025

SCALE: AS NOTED

PAGE #: 2 OF 3

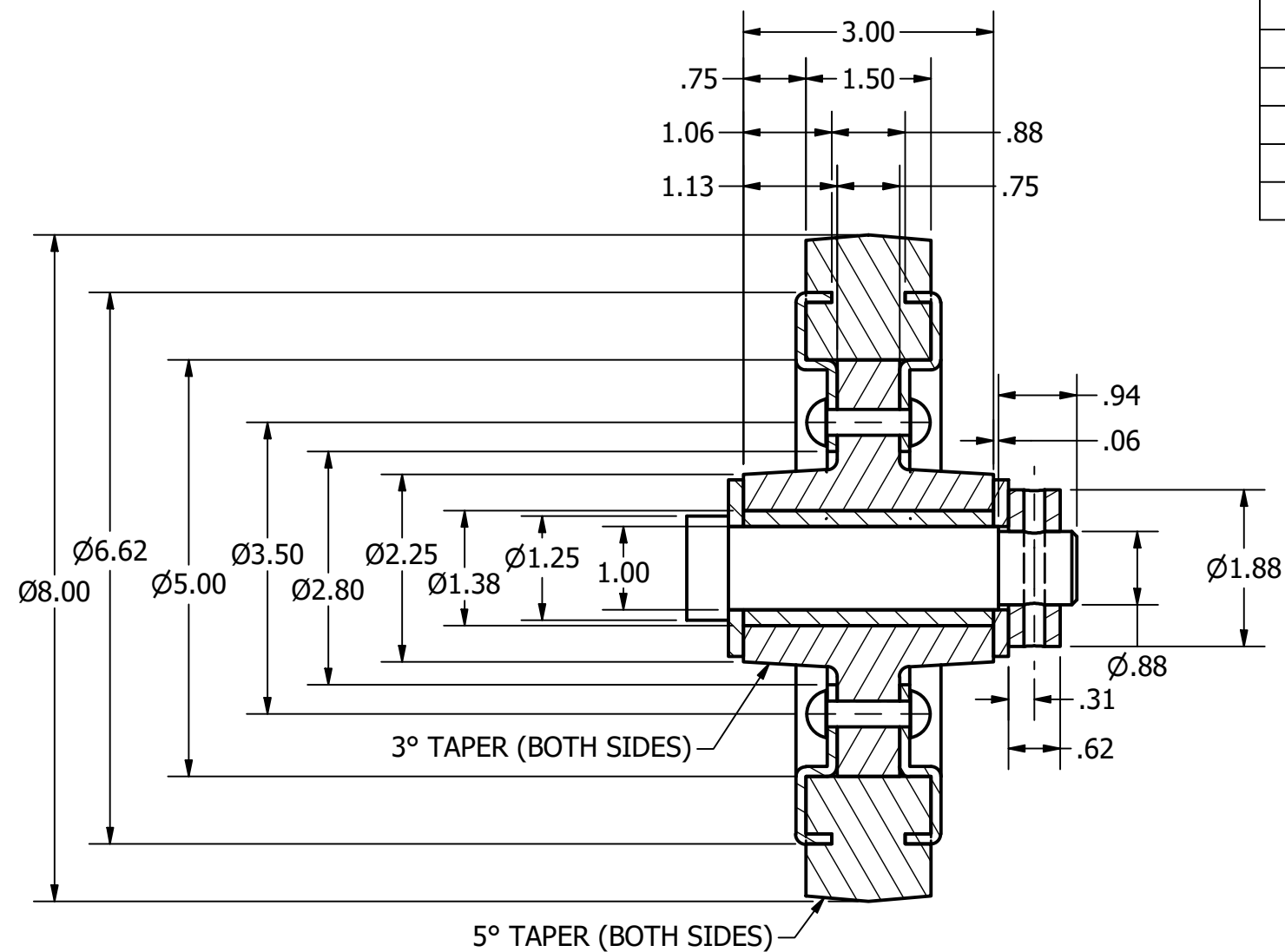

DIGITAL DESIGN
GRAPHICS
TECHNOLOGY

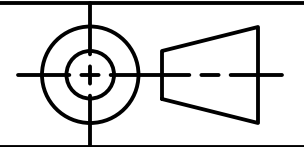

WHEEL SECTION VIEW
SCALE 1 / 2

LEGEND: